



GSM/UMTS/LTE ANTENNA

Antenna LTE OMNI OM58,
690-2600 MHz, 5 dBi, SMA(m),
Cable .195/3m

AO-ALTE-OM58

SECTRON company offers a wide portfolio of GSM/UMTS/LTE antennas with various versions differing in shape, level of gain and manner of attachment. SECTRON guarantees a compatible connection between an antenna and all antenna adaptors produced by SECTRON.

BENEFITS

- Easy installation
- High frequency range
- Low VSWR
- IP67



FEATURES

AO-ALTE-OM58

Technology	GSM/UMTS/LTE
Frequency bands	700/800/850/900/1700/1800/1900/2100/2300/2500/2600MHz
Bandwidth	-
Gain	5 dBi
VSWR	<1.9:1
Impedance	50 Ohm
Directivity	Omnidirectional
Beam angle	Attached graphs below
Polarization	Linear
Maximum input power	50 W
Power voltage	-
Dimensions	∅ 20 x 269 mm
Weight	750 g
Operating temperature	-40 to +60 °C
Execution	External
Method of attachment	Screw Mount
Cable type	.195
The cable length	3000 mm
Connector type	SMA(m)
Certification	RoHS, IP67

DRAWING

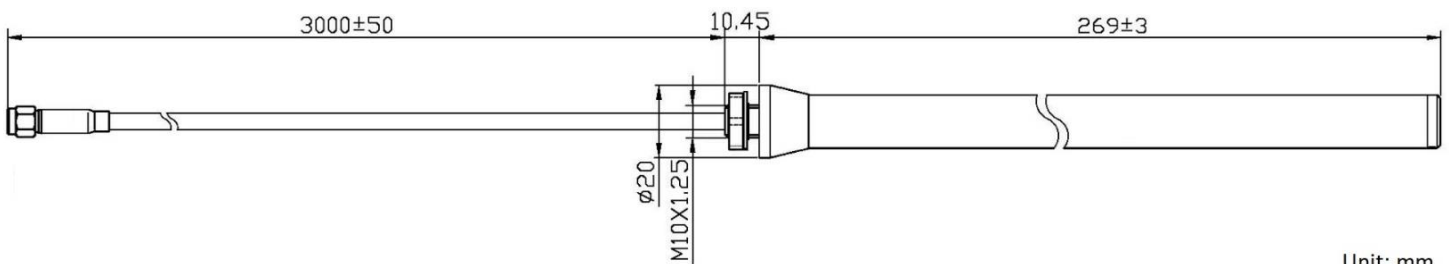

S_{11} - Return Loss [dB]

S11 Refl Load RefLvl: 0 dB Res: 10 dB/Div

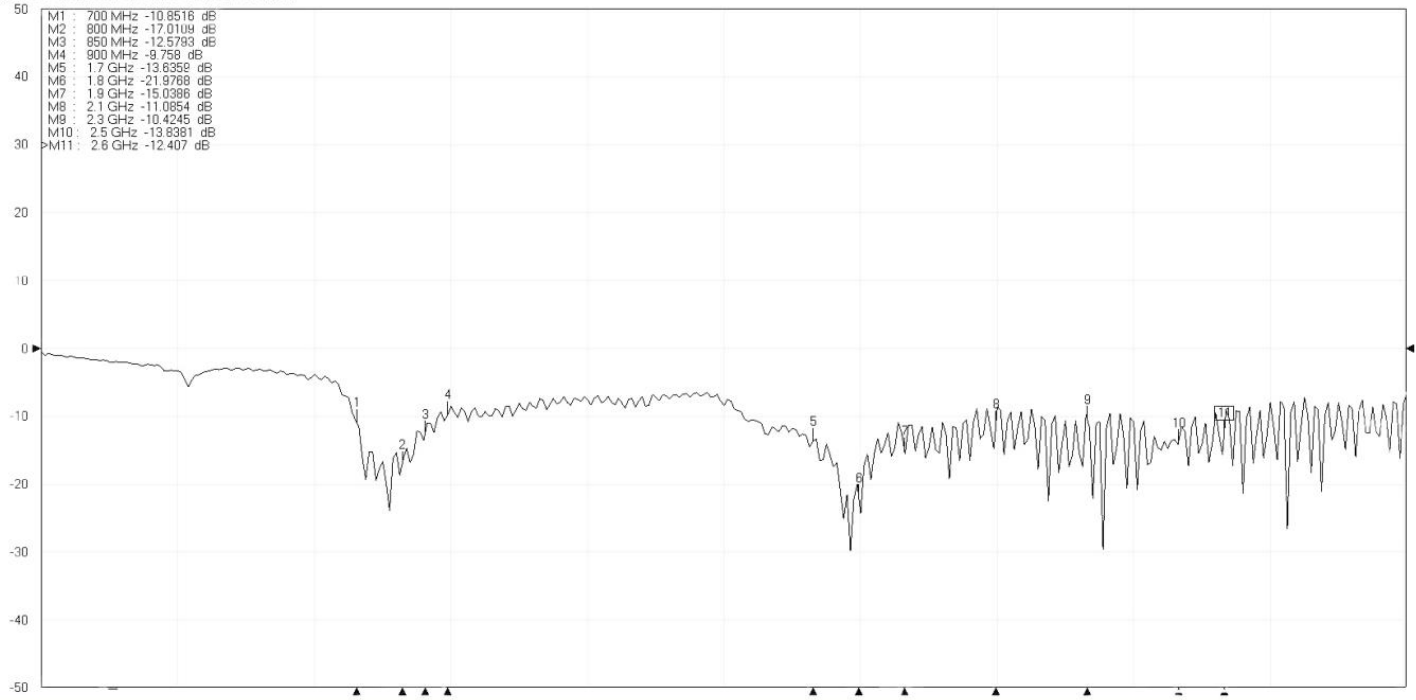

Ch1 TR Start 10 MHz Stop 3 GHz IFBW 1 kHz Avg OFF Measuring State UNCORR

2D RADIATION PATTERN

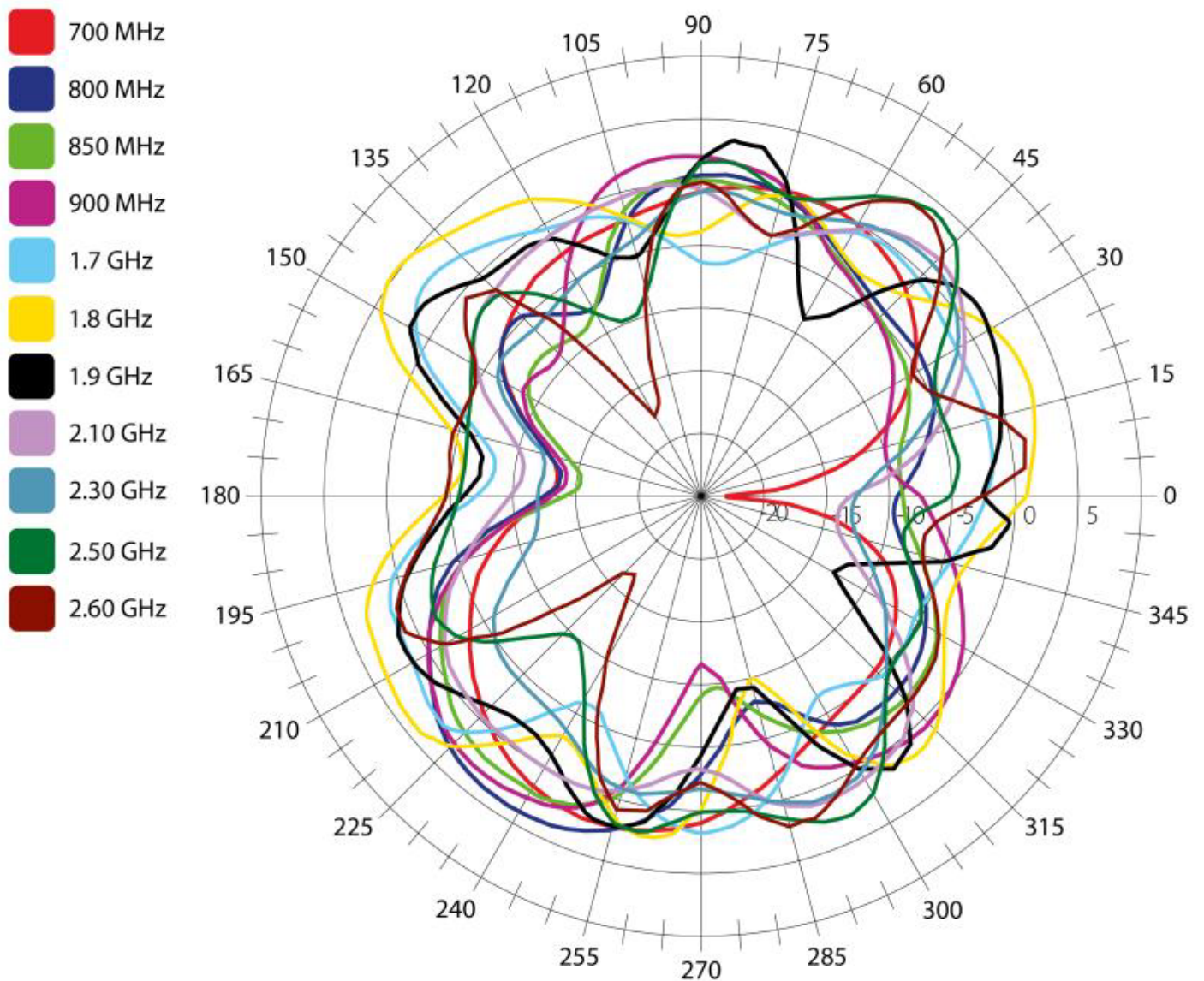

VARIANTS

AO-ALTE-OM58

Different connector variants or cable lengths are available on request.

CONTACTS

SECTRON s.r.o. Josefa Šavla 1271/12
709 00 Ostrava 9, Czech Republic

WWW.SECTRON.CZ
Tel.: +420 556 621 020