

## U.FL(f) to SMA-RP(pin m), LP-088, 10 cm AM-88-USRP10AP-X

SECTRON company offers a wide portfolio of high-quality handmade cable adaptors in various versions for M2M applications.

SECTRON product portfolio includes brand connectors and coaxial cables in diameters from 0.8 mm to 10 mm suitable for frequencies up to 6 GHz. Using the latest technologies and our experience in the field, we will manufacture and test each RF cable adaptor exactly for your device.



### BENEFITS

- High reliability thanks to precise design
- Low Insertion loss
- Low VSWR

### FEATURES

Frequency range	Up to 4 GHz
Impedance	50 ± 2 Ohm
Maximum VSWR	< 1.25:1 / 4GHz
Maximum Insertion Loss	-0.55 dB / 4 GHz
Voltage Power	30 V
Maximum operating voltage	200 V AC/1 min
Cable type	Cable 088 series, Diameter 1.37 mm micro coax
Cable length	0.1 m
Connector type A	SMA-RP (pin m) panel (AO-SMA-KMPR1)
Connector type B	U.FL-LP-088
Operating temperature	-40 °C to +90 °C
Weight	4.31 g
Certification	RoHS

### DRAWING

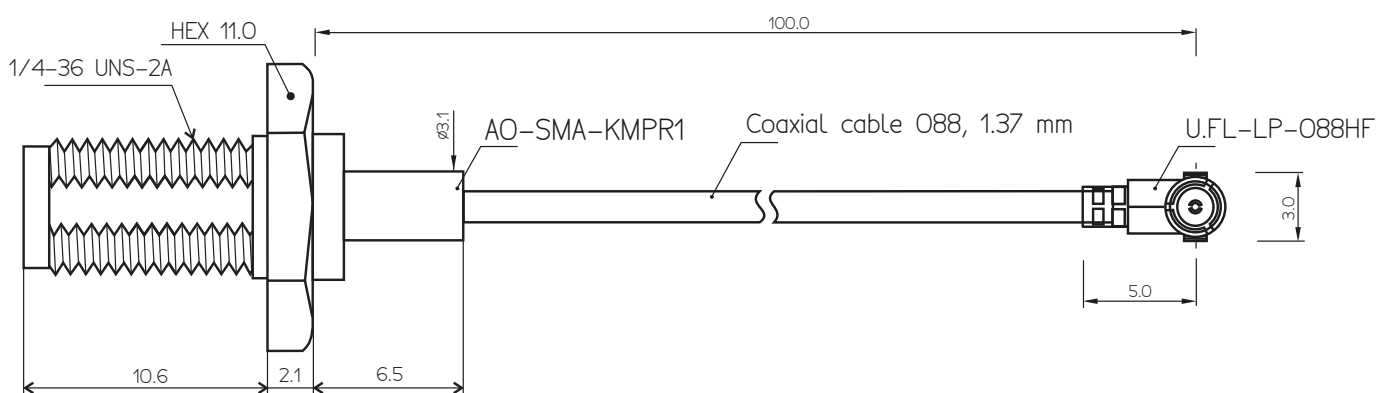

UNIT: mm

# CONNECTORS PARAMETERS

Connector U.FL-LP-088

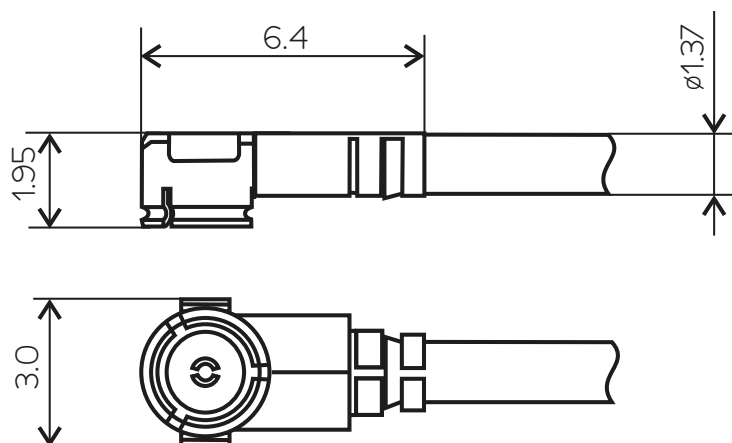

Connector SMA-RP (pin m) panel (AO-SMA-KMPR1)

RECOMMENDED  
MOUNTING HOLE

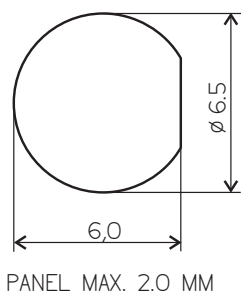

NUT



WASHER

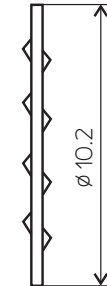

O-RING

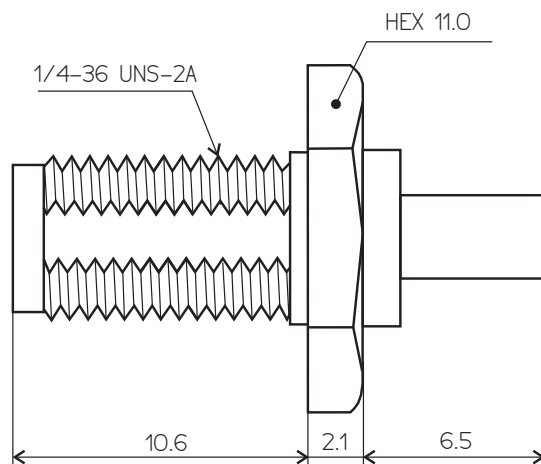
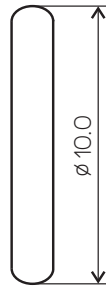

UNIT: mm

U.FL connector material

Shell	PH Bronze, Silver plated
Female Center Contact	PH Bronze, Gold plated
Insulator	Polybutylene terephthalate (PBT)
Mating Cycles	30 cycles

SMA connector material

Body	Brass, Gold plated
Pin	Brass, Gold plated
Insulator	Teflon
Sleeve	Brass, Nickel plated
Lock Washer	Brass, Gold plated
Nut	Brass, Gold plated
O-ring	Silicone rubber, Red
Mating Cycles	500 cycles

CZ: +420 556 621 030  
INT: +420 556 621 020

CZ: obchod@sectron.cz  
INT: sales@sectron.cz

SECTRON s.r.o.  
Josefa Šavla 12, 709 00 Ostrava, Czech Republic

# CABLE PARAMETERS

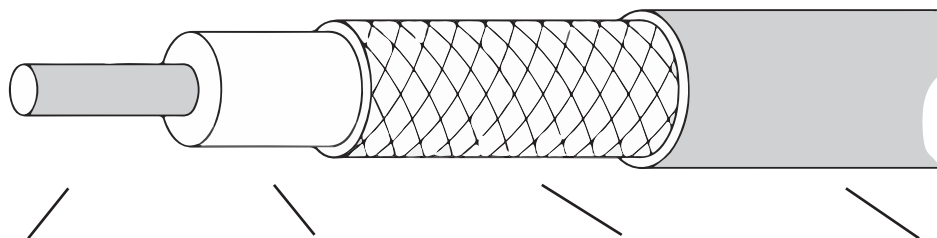

Inner Conductor	Insulation	Braid shield	Jacket
Material: Silver-plated Cu wire	Material: FEP	Material: Tinned Cu wire	Material: FEP
Stranding: 7×0.102 mm		Type braid: 5×∅0.05 mm	
Outer diameter: 0.306±0.02 mm	Outer diameter: 0.9±0.03 mm	Outer diameter: 1.13±0.05 mm	Outer diameter: 1.37±0.05 mm

# ADAPTOR MEASUREMENT

**GRAPH VSWR - VOLTAGE STANDING WAVE RATIO [-]**

VSWR

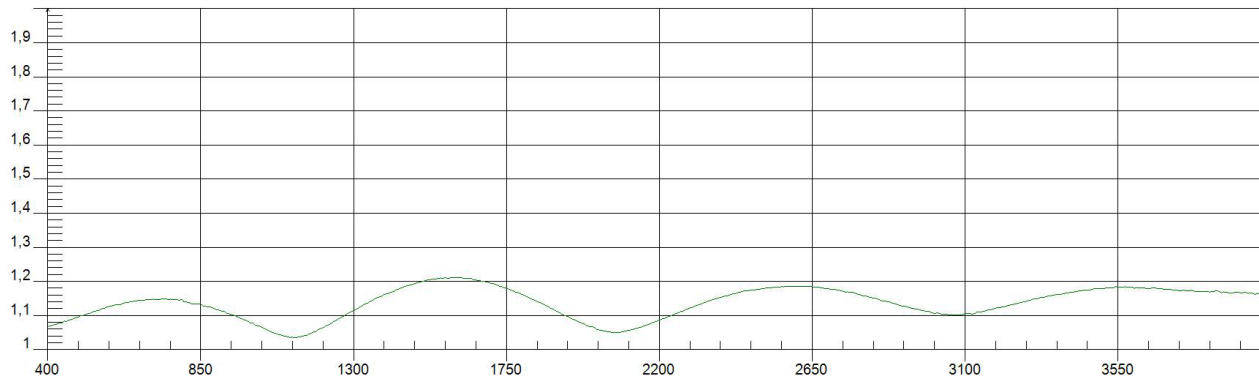

**GRAPH S12 - INSERTION LOSS [dB]**

dB

